

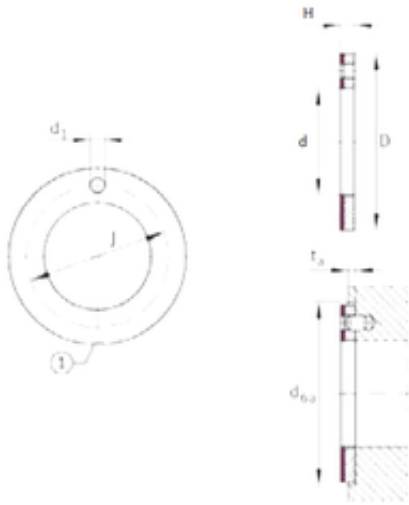

WUXI IKC MACHINERY BEARING CO., LTD.



INA EGW32-E40 plain bearings

Bearing No. EGW32-E40

Size	32x54x1.5 mm
Bore Diameter	32 mm
Outer Diameter	54 mm
Width	1,5 mm
d	32 mm
D	54 mm
H	1,5 mm
t	1 mm
d1	4 mm
J	43 mm
da	54 mm
Category	Sleeve Bearings
Inventory	0.0
Manufacturer Name	SCHAEFFLER GROUP
Minimum Buy Quantity	N/A
Weight / Kilogram	0.021
EAN	4012802756593
Product Group	B04264
Profile	Thrust Washer
Material Description	Steel Backing, Bronze Innerstructure, PTFE-lead Overlay
Material	Permaglide P10
Inch - Metric	Metric
Long Description	32MM Nominal Bore; 54MM Nominal Outside Diameter; 1.5MM Length Thru Bore; Thrust Washer

EGW32-E40 Bearing 2D drawings and 3D CAD models



WUXI IKC MACHINERY BEARING CO., LTD.

	Profile; Steel Backing, Bronze Innerstructure, PTFE-lead Overlay; Permaglide P10 Material
Category	Sleeve Bearings
UNSPSC	31171515
Harmonized Tariff Code	84833080
Noun	Bearing
Keyword String	Plain
Manufacturer URL	http://www.ina.com
Manufacturer Item Number	PAW32P10
Weight / LBS	0.047
Length Thru Bore	0.059 Inch 1.5 Millimeter
Nominal Bore	1.26 Inch 32 Millimeter
Nominal Outside Diameter	2.126 Inch 54 Millimeter